



FC226

**SA SUFFI LA CHASSE BRUNET, ST. SAVIOUR, JERSEY,
CHANNEL ISLANDS, JE2 7TN**

Asking Price

£1,495,000

FINE & COUNTRY
JERSEY

Property details

FREEHOLD - This spacious 4/5 bedroom family home is situated in a popular residential area of St Saviour close to primary and secondary schools, local amenities at Five Oaks and easy reach to St Helier town centre.

The property offers spacious accommodation throughout; comprising; good sized eat-in kitchen, large living room, separate dining room, a study which could be used as a 5th bedroom, shower room and utility room. Then on the first floor you will find a large principle bedroom with en-suite bathroom, a further 3 double bedrooms (two of which have built-in wardrobes) and a family bathroom.

Externally the property benefits from a beautiful South-West facing laid to lawn garden, paved seating area with pergola and a heated swimming pool. Single garage with plenty of scope to add a double garage, plus parking for an additional 4 or 5 cars and the opportunity to create more parking and extend for someone looking for more space.

Outside

Large South-West facing, private and fully enclosed mainly lawn garden.

Heated swimming pool.

Single integral garage with plenty of scope to add a double garage.

Ample parking with the opportunity to create more.

Services

All mains services excluding gas.

Loft is fully boarded.

Fully double glazed.

Directions

The property is next to St Saviours school and is accessed by going round and coming down the one way of Chasse Brunet at the back of the school.







GROUND FLOOR
1254 sq.ft. (116.5 sq.m.) approx.



1ST FLOOR
971 sq.ft. (90.2 sq.m.) approx.

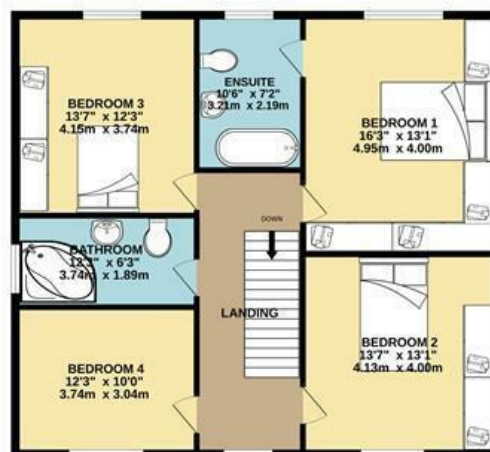

TOTAL FLOOR AREA : 2225 sq.ft. (206.7 sq.m.) approx.

Whilst every attempt has been made to ensure the accuracy of the floorplan contained here, measurements of doors, windows, rooms and any other items are approximate and no responsibility is taken for any error, omission or mis-statement. This plan is for illustrative purposes only and should be used as such by any prospective purchaser. The services, systems and appliances shown have not been tested and no guarantee as to their operability or efficiency can be given.
Made with Metropix ©2022

Call us on

01534 888855

jersey@fineandcountry.com

www.fineandcountry.je

5 King Street, St Helier, Jersey, JE2 4WF

Agents Note: Whilst every care has been taken to prepare these particulars, they are for guidance purposes only. All measurements are approximate and are for general guidance purposes only and whilst every care has been taken to ensure their accuracy, they should not be relied upon and potential buyers are advised to recheck the measurements.